

**DRAWN BY:** MAM  
**DATE:** 11-13-06

**REVISIONS**

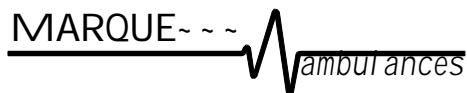

**DRAWING TITLE:** STREETSIDE INTERIOR VIEW - 68" H.R.  
**MODEL/TYPE/CHASSIS:** TYPE 1 - 144 CADET  
**DEALER / CUSTOMER:** REV/ TACOM  
**UNIT NUMBER:** 4285-96 **PRINT NUMBER:** T1-144CADT-008

Drawing is representative only - Dimensions shown are approximate and may vary from the completed vehicle DO NOT scale this drawing!

FERNO 520 DOUBLE BRACKETS INSTALLED?

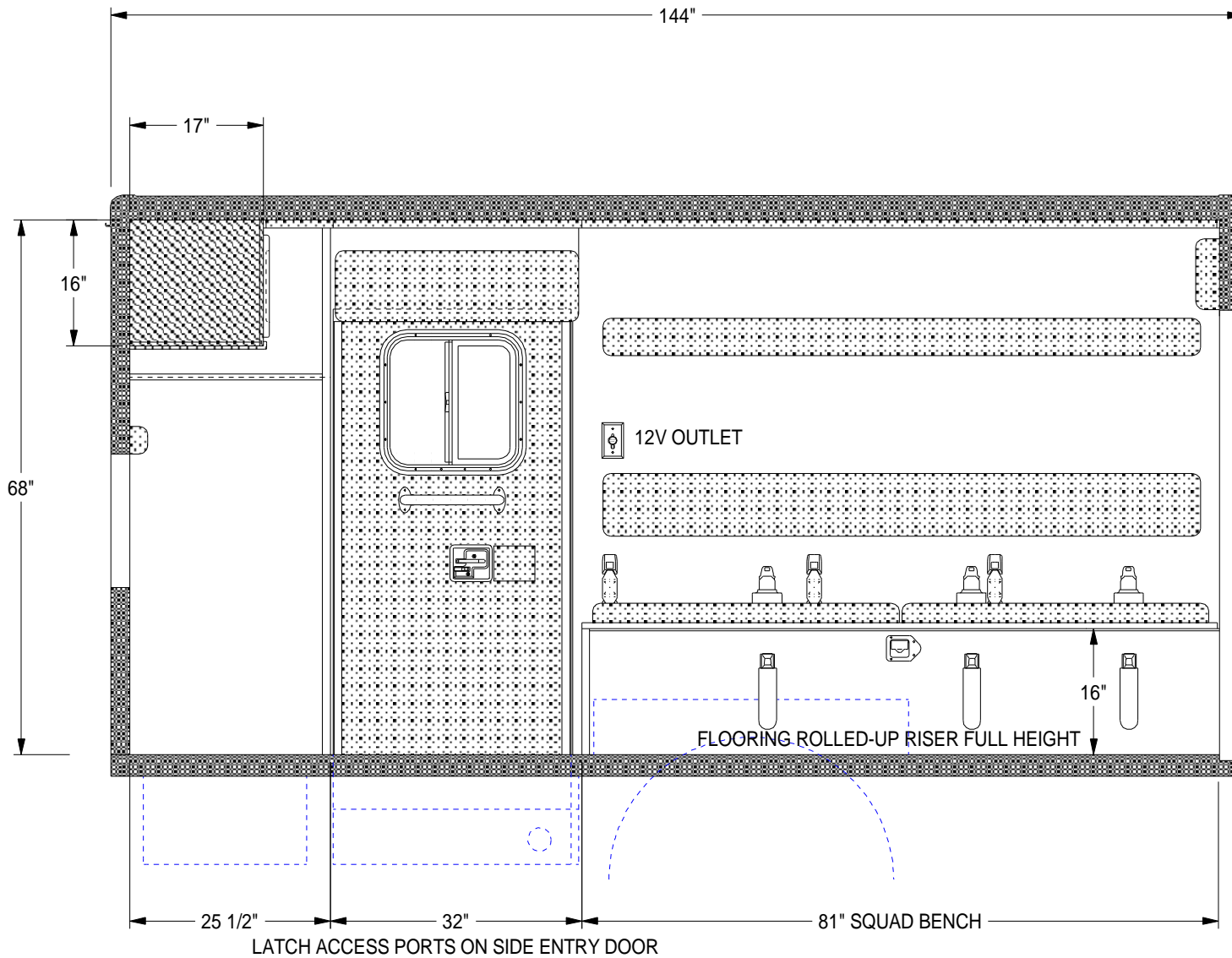

**DRAWN BY:** Initials  
**DATE:** 01-01-06

Drawing is representative only - Dimensions shown are approximate and may vary from the completed vehicle DO NOT scale this drawing!

| REVISIONS |
|-----------|
|           |
|           |
|           |

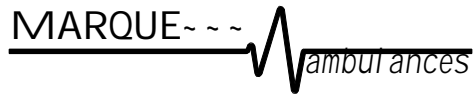

**DRAWING TITLE:** CURBSIDE INTERIOR VIEW - 68" H.R.  
**MODEL/TYPE/CHASSIS:** TYPE 1 - 144 CADET  
**DEALER / CUSTOMER:** DEALER/CUSTOMER NAME  
**UNIT NUMBER:** ### **PRINT NUMBER:** T1-144CADT-007

LATCH ACCESS PORTS ON REAR ENTRY DOOR

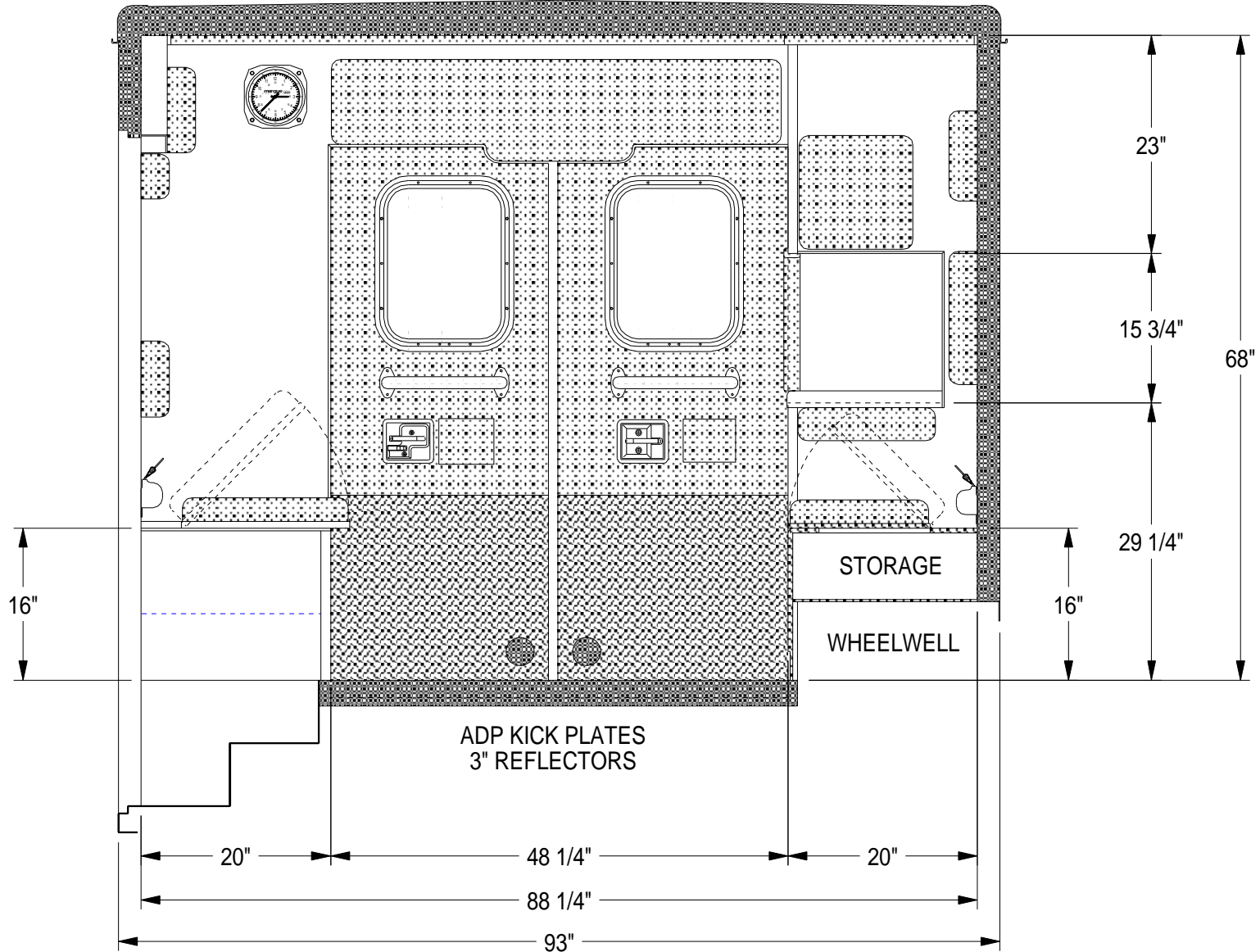

**DRAWN BY:** MAM  
**DATE:** 11-13-06  
Drawing is representative only - Dimensions shown are approximate and may vary from the completed vehicle DO NOT scale this drawing!

| REVISIONS |
|-----------|
|           |
|           |
|           |

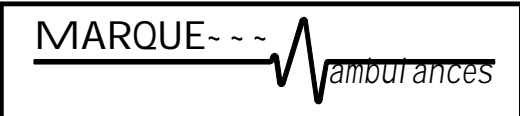

|                            |                               |
|----------------------------|-------------------------------|
| <b>DRAWING TITLE:</b>      | REAR INTERIOR VIEW - 68" H.R. |
| <b>MODEL/TYPE/CHASSIS:</b> | TYPE I - 144 CADET            |
| <b>DEALER / CUSTOMER:</b>  | REV/ TACOM                    |
| <b>UNIT NUMBER:</b>        | 4285-96                       |
| <b>PRINT NUMBER:</b>       | T1-144CADT-006                |

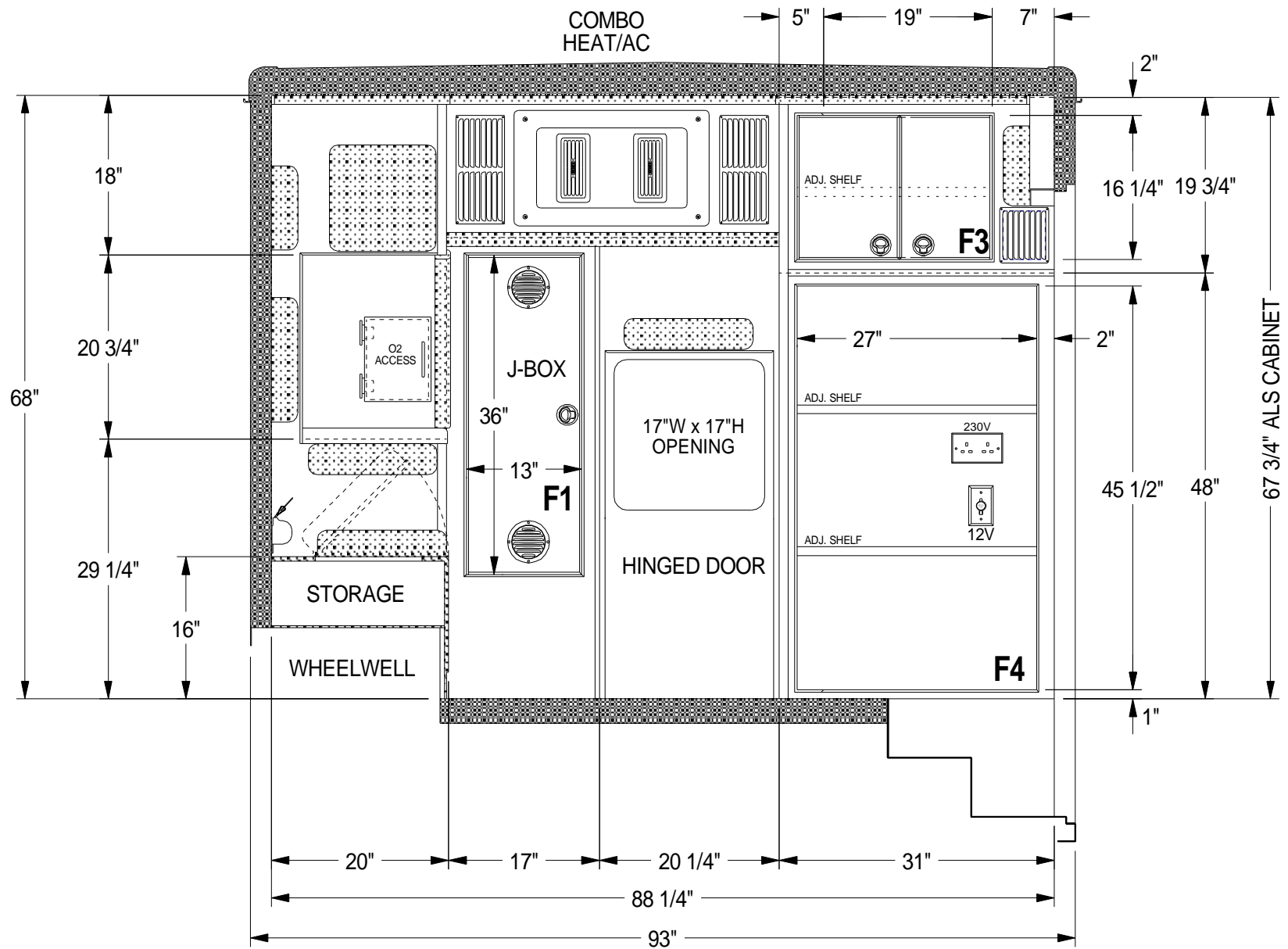

**DRAWN BY:** MAM  
**DATE:** 11-13-06  
Drawing is representative only - Dimensions shown are approximate and may vary from the completed vehicle DO NOT scale this drawing!

| REVISIONS |
|-----------|
|           |
|           |
|           |

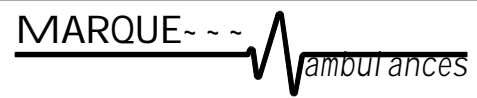

**DRAWING TITLE:** FRONT INTERIOR VIEW - 68" H.R.  
**MODEL/TYPE/CHASSIS:** TYPE 1 - 144 CADET  
**DEALER / CUSTOMER:** REV/ TACOM  
**UNIT NUMBER:** 4285-96      **PRINT NUMBER:** T1-144CADT-005

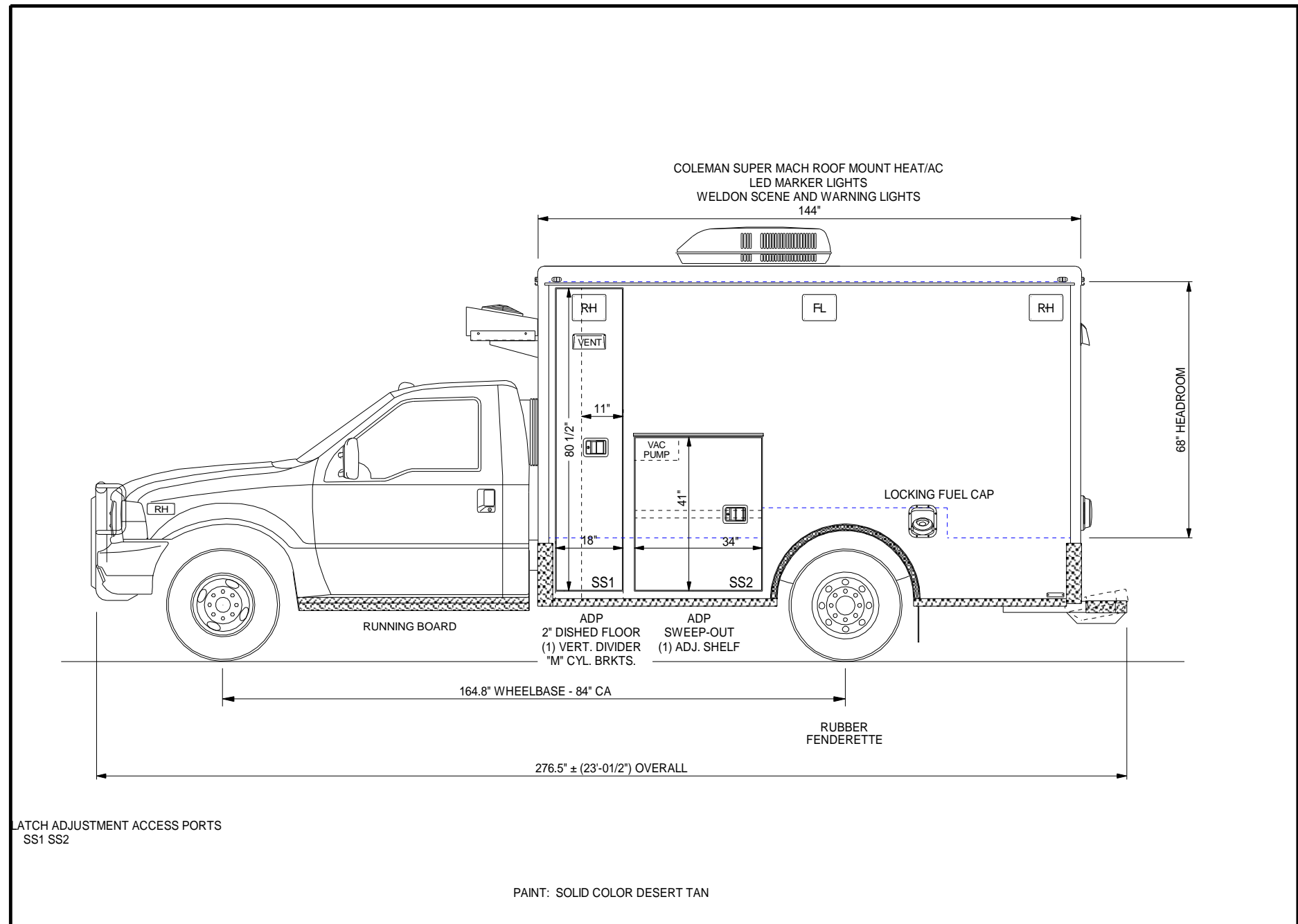

DRAWN BY: MAM  
DATE: 11-13-06

REVISIONS

MARQUE ~ ~ ~  
ambulances

DRAWING TITLE: STREETSIDE EXTERIOR VIEW - 68" H.R.  
TYPE/MODEL/CHASSIS: TYPE 1 - 144 CADET - FORD F350  
DEALER / CUSTOMER: REV/ TACOM  
UNIT NUMBER: 4285-96 PRINT NUMBER: T1-144CADT-004

Drawing is representative only - Dimensions shown are approximate and may vary from the completed vehicle DO NOT scale this drawing!

COLEMAN SUPER MACH ROOF MOUNT HEAT/AC  
 LED MARKER LIGHTS  
 WELDON SCENE AND WARNING LIGHTS

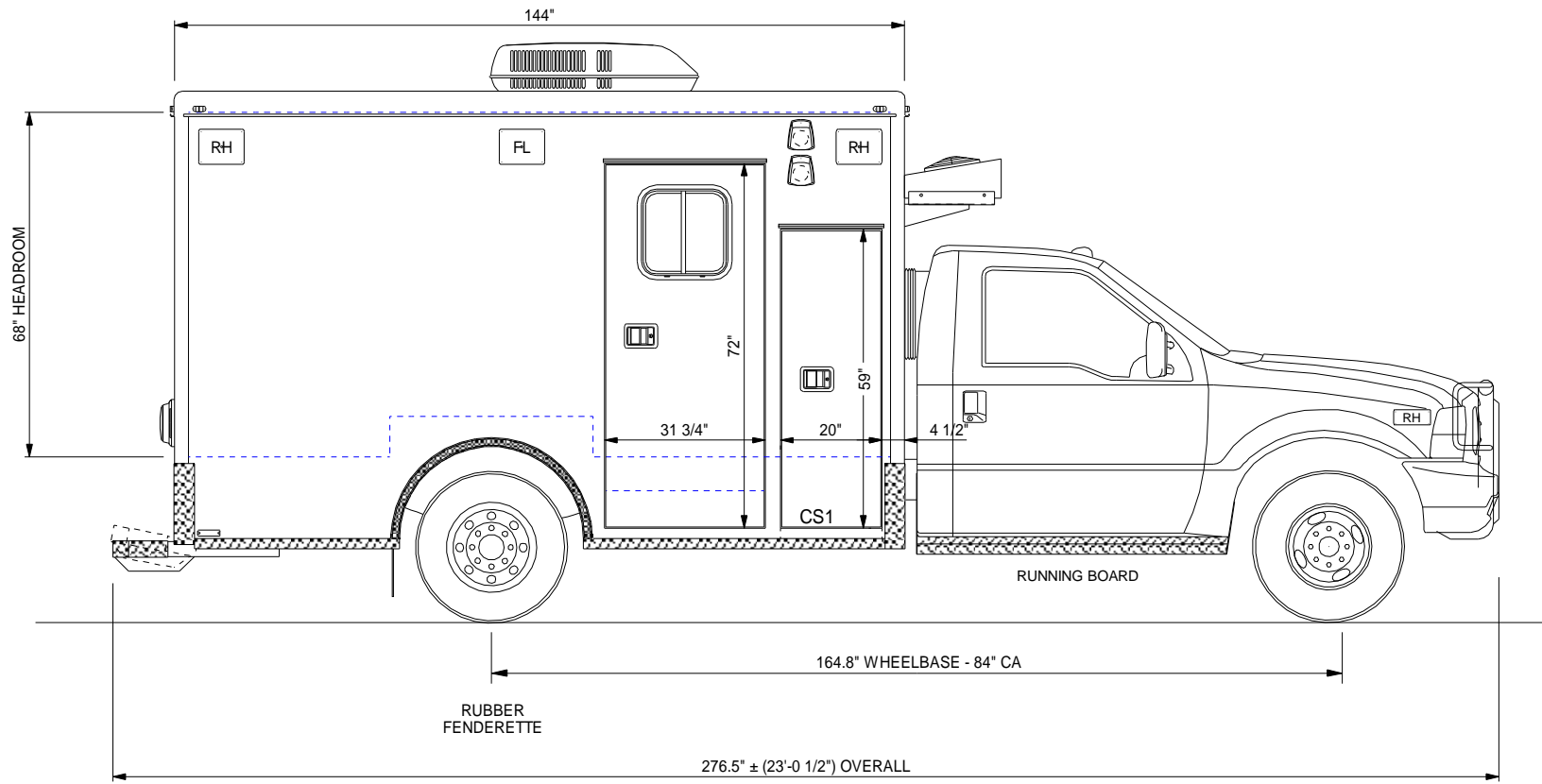

LATCH ADJUSTMENT ACCESS PORTS  
 CS1

**DRAWN BY:** MAM  
**DATE:** 11-13-06

**REVISIONS**

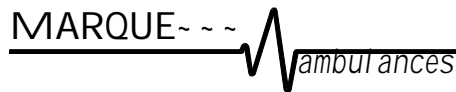

**DRAWING TITLE:** CURBSIDE EXTERIOR VIEW - 68" H.R.  
**TYPE/MODEL/CHASSIS:** TYPE I - 144 CADET - FORD F350  
**DEALER / CUSTOMER:** REV/ TACOM  
**UNIT NUMBER:** 4285-96 **PRINT NUMBER:** T1-144CADT-003

Drawing is representative only - Dimensions shown are approximate and may vary from the completed vehicle. DO NOT scale this drawing!

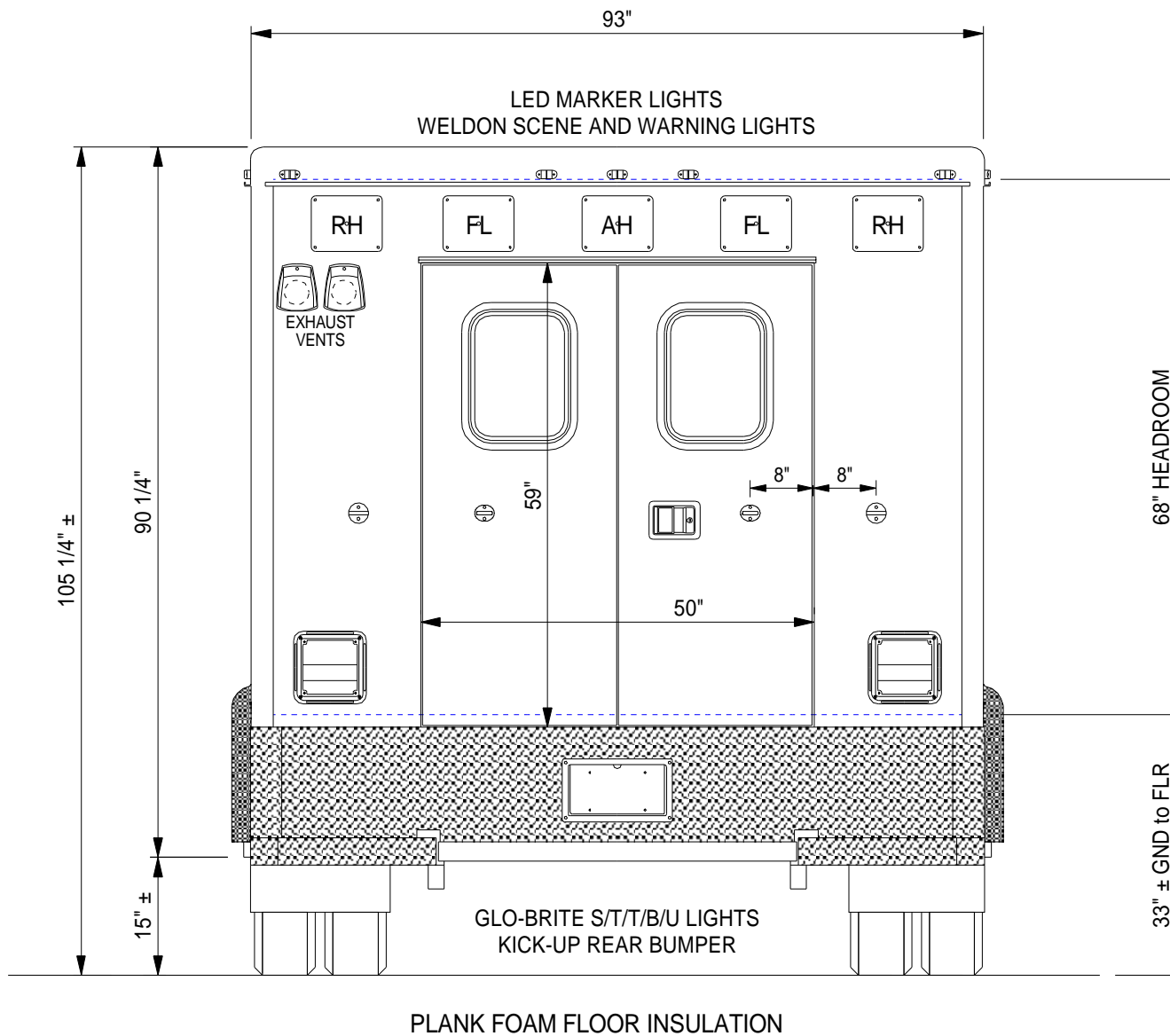

DRAWN BY: MAM  
 DATE: 11-13-06  
 Drawing is representative only - Dimensions shown are approximate and may vary from the completed vehicle. DO NOT scale this drawing!

| REVISIONS |
|-----------|
|           |
|           |
|           |

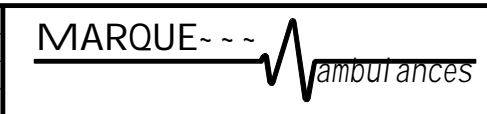

|                     |                                |
|---------------------|--------------------------------|
| DRAWING TITLE:      | REAR EXTERIOR VIEW - 68" HR.   |
| TYPE/MODEL/CHASSIS: | TYPE I - 144 CADET - FORD F350 |
| DEALER / CUSTOMER:  | REV/ TACOM                     |
| UNIT NUMBER:        | 4285-96                        |
| PRINT NUMBER:       | T1-144CADT-002                 |

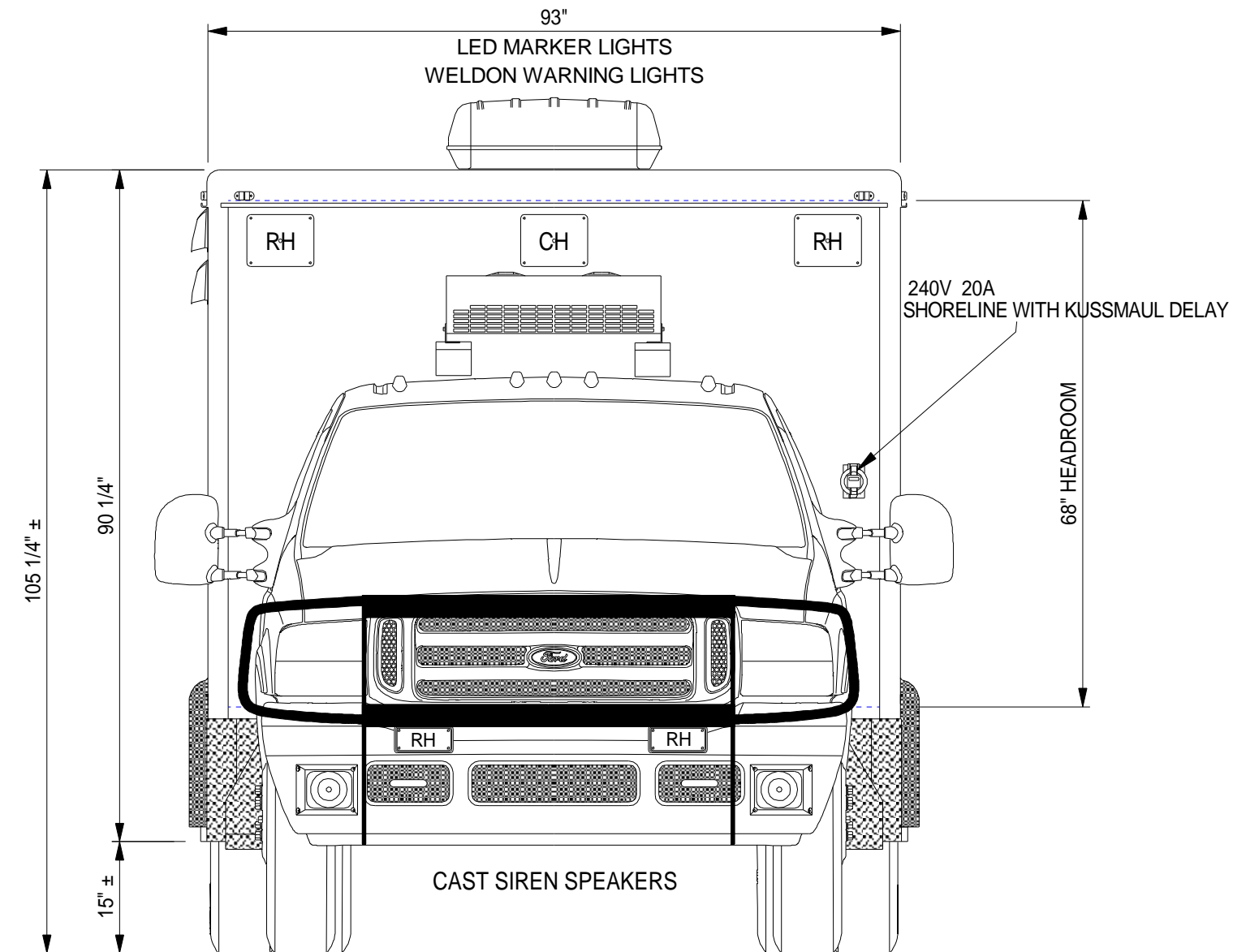

DRAWN BY: MAM  
DATE: 11-13-06

REVISIONS

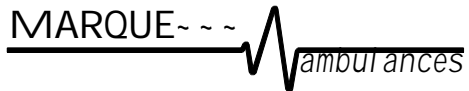

DRAWING TITLE: FRONT EXTERIOR VIEW - 68" H.R.  
 TYPE/MODEL/CHASSIS: TYPE 1 - 144 CADET - FORD F350  
 DEALER / CUSTOMER: REV/ TACOM  
 UNIT NUMBER: 4285-96    PRINT NUMBER: T1-144CADT-001

Drawing is representative only - Dimensions shown are approximate and may vary from the completed vehicle DO NOT scale this drawing!

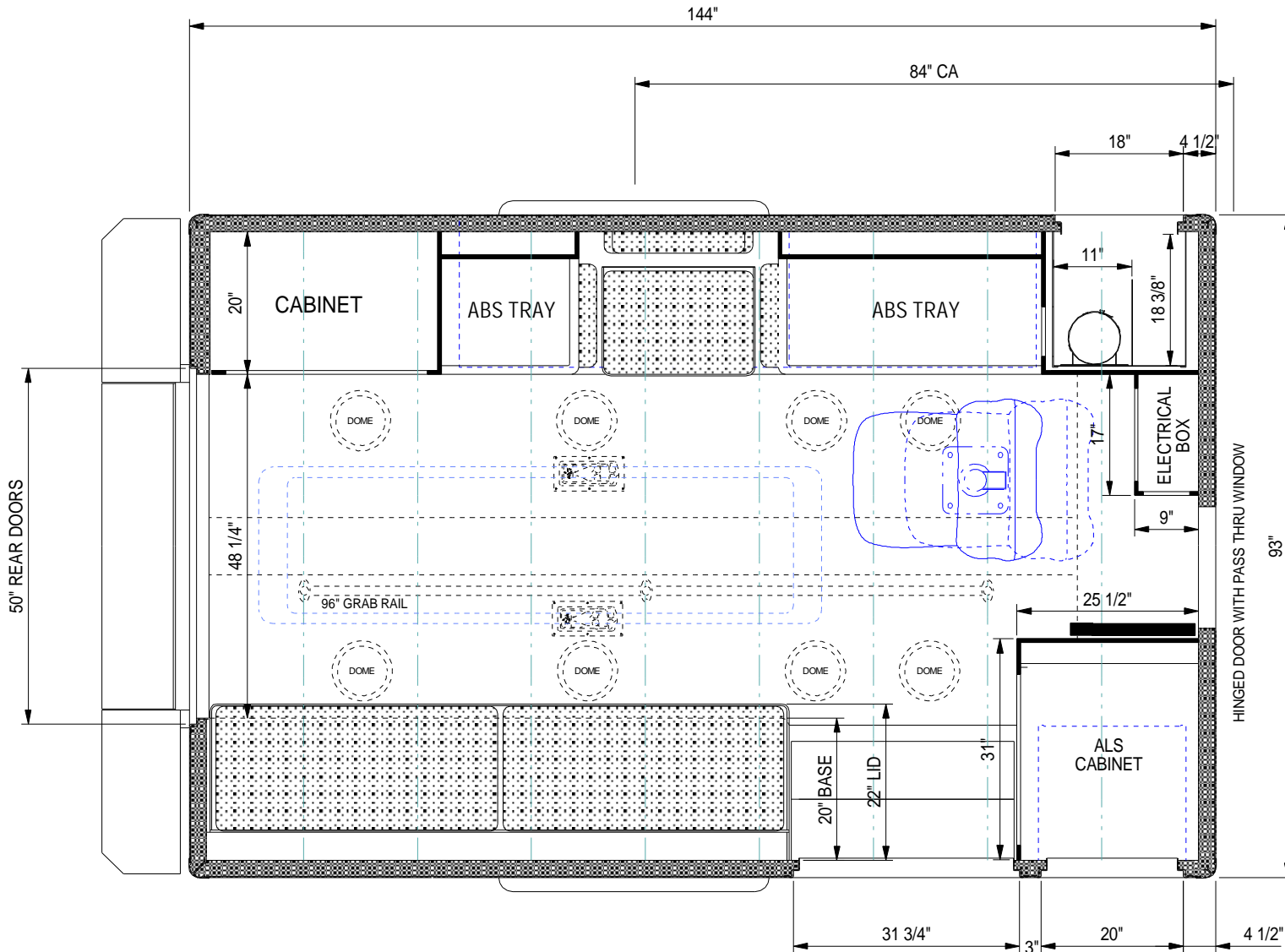

**DRAWN BY:** MAM  
**DATE:** 11-13-06

**REVISIONS**

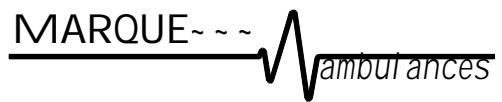

**DRAWING TITLE:** FLOOR PLAN  
**TYPE/MODEL/CHASSIS:** TYPE I - 144 CADET

**DEALER / CUSTOMER:** REV/ TACOM  
**UNIT NUMBER:** 4285-96 **PRINT NUMBER:** T1-144CADT-009

Drawing is representative only - Dimensions shown are approximate and may vary from the completed vehicle DO NOT scale this drawing!